

7-31-2004

Eli Jackson Cemetery Pharr, Texas 108, 2004-2006

Diana Cardenas

Follow this and additional works at: <https://scholarworks.utrgv.edu/hidalgohist>



Part of the [History Commons](#)

Recommended Citation

Hidalgo County Historical Collection, UTRGV Digital Library, The University of Texas – Rio Grande Valley

This Book is brought to you for free and open access by the Special Collections and Archives at ScholarWorks @ UTRGV. It has been accepted for inclusion in Hidalgo County Historical Collection by an authorized administrator of ScholarWorks @ UTRGV. For more information, please contact justin.white@utrgv.edu, william.flores01@utrgv.edu.

HISTORIC TEXAS CEMETERY DESIGNATION

List additional descriptions or information on separate pages, if necessary.

1. **CEMETERY/BURIAL** Eli Jackson Cemetery County Hidalgo County, TX
Also known as Eli Jackson Brewster Cemetery, Jackson Cemetery

2. **LOCATION/SIZE** Metes and bounds, any survey references (e.g., L. Garrett Survey, Section 2, Abstract 5248):
United States Department of the Interior Geological Survey; Las Milpas Quadrangle, Texas-Hidalgo County;
SW/4 San Juan 15' Quadrangle; 7.4 miles south of Pharr, TX on Doffin Road, 500 feet east of "I" Road;
Eli Jackson Cemetery measures approximately 120' E-W by 108' N-S

Street address, town, city, zip code and/or specific directions from nearest town, distance from nearest intersection or permanent landmark or state or county road:
From Pharr, TX travel south seven miles on U S 281 to Fay's Corner, turn east .8 miles on Old Military
Highway; turn south on "I" Road, .4 miles across levee; turn toward Jackson Ranch Church; drive about
500 feet on Doffin Road northeast of church; Eli Jackson Cemetery is located about 400 feet north, against
the bank of an elevated canal

Optional: UTM: Grid Zone: 14 Northing: 8 1 2 5 0 Easting: 8 5 4 5 0
Optional: Latitude: 26° 05' 10.5" N Longitude: 98° 10' 56.5" W

3. THE CEMETERY MEETS THE FOLLOWING CRITERIA

At least 50 years of age Historic associations
(Two basic criteria govern the approval for the Historic Texas Cemetery designation: (1) The cemetery must be at least 50 years old, and (2) deemed worthy of preservation for its historic associations. The very nature of a cemetery being a landmark of a family's or community's presence is considered to validate the criteria of historic associations.)

4. **ORIGINS** Texas courts hold that no particular instrument or ceremony is required to dedicate land to cemetery purposes. Its actual use as a cemetery is sufficient (Damon v. State, 52 S.W. 2d 368 Tex. 1932). If known, please provide information as to the ownership of the land out of which this cemetery was set aside and when this took place:
Eli Jackson established cemetery in 1865 on land he inherited from his father Nathaniel Jackson (1800-1865)
who founded Jackson Ranch in 1857 on land known as *Porcion 71*, land granted to Narcisco Cavazos by the
Crown of Spain in 1769.

5. TRUSTEESHIP OR AUTHORITY OVER CEMETERY Public Private Both

Name of individual, trustee, political entity, organization or religious institution associated with cemetery or whose land surrounds cemetery Diana Cardenas

Address [REDACTED] City [REDACTED] Zip [REDACTED]
Phone [REDACTED] Fax () [REDACTED] Email [REDACTED]

Contact person, sexton or caretaker Diana Cardenas
Address [REDACTED] City [REDACTED] Zip [REDACTED]
Phone [REDACTED] Fax () [REDACTED] Email [REDACTED]

6. OWNERSHIP OF LAND ADJACENT TO CEMETERY

(Please indicate on the site map the location of each owner's property)

Owner no. 1 Nino Family
Address [REDACTED] City [REDACTED] Zip [REDACTED]
Phone () _____ Fax () _____ Email address _____

Owner no. 2 Nino Family (Gus-deceased)
Address [REDACTED] City [REDACTED] Zip [REDACTED]
Phone () _____ Fax () _____ Email address _____

Owner no. 3 Rosa Trevino (deceased)
Address [REDACTED] City [REDACTED] Zip [REDACTED]
Phone () _____ Fax () _____ Email address _____

Owner no. 4 Jose C. & Irma Garza (Wetfarm/Field)
Address [REDACTED] City [REDACTED] Zip [REDACTED]
Phone () _____ Fax () _____ Email address _____

7. HISTORICAL DESIGNATIONS

Is property listed in the National Register of Historic Places? Yes No

If Yes, date of listing _____

Does this cemetery already have an Official Texas Historical Marker? Yes No

If Yes, title and date of marker _____

8. PERSON COMPLETING THIS FORM

Name Diana Cardenas Date July 31, 2004

Affiliation Eli Jackson Cemetery Administrator

Address [REDACTED] City [REDACTED] Zip [REDACTED]

Phone [REDACTED] Fax () _____ Email address [REDACTED]

REQUIRED ATTACHMENTS:

- Narrative history and local context of the cemetery (one page)
- Current black & white photos (and historical photos if available); color prints will not be accepted except as supplemental to a core set of black & white photos, see page 4 of instructions.
- Documentation for the *Affidavit of Dedication for Cemetery Purposes* (site map)
- Processing fee of \$25 (non-refundable)

ADDITIONAL INFORMATION

Approximate number of burials 150 Date/name of first known interment Nathaniel Jackson b. 1800-d. 1865
(unmarked grave); George Brewster d. 1896 (earliest marked grave)

Do cemetery burial or association records exist? Yes No
Has the cemetery been inventoried? Yes No

Author, title, date, location, availability of above records/inventories or other published material about this cemetery/site
De Leon Funeral Home Announcements-Family documents; Surveyed by Joe Fallin and Dale Swartzmiller on Nov. 5, 1976; Re-surveyed by Ramon Montalvo Sr. and Fran Isbell in 1988; Re-surveyed by Diana Cardenas on Nov. 1, 2002; Completed Survey and Map Census by Diana Cardenas and Valerie Resto on November 23, 2003; Eli Jackson Cemetery Census in Special Collections, University of Texas Pan American Library (1201 West University Dr., Edinburg, TX

Cemetery status Active Inactive
Scheduled cleanings? Yes No If yes, when? Monthly
Association meetings? Yes No If yes, when? _____
Accessible to the public? Yes No Evidence of unmarked graves? Yes No
Evidence of vandalism? Yes No Problems with erosion? Yes No

MONUMENTS AND GRAVESTONES

1936 Texas Centennial Markers Yes No (if Yes, list/briefly describe) _____

Does this cemetery contain (an) individual THC grave marker(s)? Yes No
If Yes, give name(s) of individual(s) _____

Statuary: Yes No (if Yes, list) Small figurines of the Virgin Mary, Jesus, Lambs, and several concrete/marble crosses

Stone markers?	<input checked="" type="checkbox"/> Yes	<input type="checkbox"/> No	Concrete markers?	<input checked="" type="checkbox"/> Yes	<input type="checkbox"/> No
Wood markers?	<input checked="" type="checkbox"/> Yes	<input type="checkbox"/> No	Zinc markers?	<input type="checkbox"/> Yes	<input checked="" type="checkbox"/> No
Handmade markers?	<input checked="" type="checkbox"/> Yes	<input type="checkbox"/> No	Obelisks?	<input checked="" type="checkbox"/> Yes	<input type="checkbox"/> No
Mausoleums?	<input type="checkbox"/> Yes	<input checked="" type="checkbox"/> No	Grave decorations?	<input checked="" type="checkbox"/> Yes	<input type="checkbox"/> No

Others: _____

VETERANS' GRAVES IN CEMETERY

War of 1812	<input type="checkbox"/> Yes	<input checked="" type="checkbox"/> No	Texas Revolution	<input type="checkbox"/> Yes	<input checked="" type="checkbox"/> No
Civil War	<input checked="" type="checkbox"/> Yes	<input type="checkbox"/> No	The Indian Wars	<input type="checkbox"/> Yes	<input checked="" type="checkbox"/> No
Mexican American War	<input type="checkbox"/> Yes	<input checked="" type="checkbox"/> No	Spanish American War	<input type="checkbox"/> Yes	<input checked="" type="checkbox"/> No
World War I	<input type="checkbox"/> Yes	<input checked="" type="checkbox"/> No	World War II	<input checked="" type="checkbox"/> Yes	<input type="checkbox"/> No
Korean War	<input checked="" type="checkbox"/> Yes	<input type="checkbox"/> No	Vietnam War	<input checked="" type="checkbox"/> Yes	<input type="checkbox"/> No

Others (e.g., Texas Rangers) _____

IDENTIFIABLE HERITAGE

Identifiable Local Historical Heritage:
 Graves associated with a specific event Wooden cross by tree, military style cut, made during Civil War along the Rio Grande by troops visiting Jackson Ranch

Early town or community ties Nathaniel Jackson (1800-1865) pioneer settler 1857; Eli Jackson (1832-1911)
Appointed Hidalgo County Commissioner 1869, elected Hidalgo County Commissioner from 1890-1893;
Nathaniel "Polo" Jackson (1875-1929) Hidalgo County Jailer, early 1900s-1929

Identifiable Cultural Heritage: (Specifics, if known)

- African heritage: 1840 Wilcox County, Alabama Census, Hidalgo County Census, W. H. Chatfield 1893 Survey
 Asian heritage: _____
 European heritage: Nathaniel Jackson
 Mexican heritage: Nathaniel "Polo" Jackson married a Mexican woman; many graves with Mexican surnames
 American Indian heritage: _____
 Other heritage(s): Many Mexicans at Jackson Ranch were of Aztec descent

Identifiable Religious Heritage: (Specifics, if known)

- Catholic: Catholic Priests performed last rites, figurines of Virgin Mary
 Islamic: _____
 Jewish: _____
 American Indian: _____
 Protestant: Church Founder Nathaniel Jackson (1800-1865) and minister were Methodist
 Others: _____

List Fraternal Organizations represented _____

FEATURES

- | | | | |
|-----------------------------|---|---------------------------|---|
| Entry gate(s) | <input checked="" type="checkbox"/> Yes <input type="checkbox"/> No | Decorative fencing | <input checked="" type="checkbox"/> Yes <input type="checkbox"/> No |
| Perimeter fencing | <input checked="" type="checkbox"/> Yes <input type="checkbox"/> No | Grave/family plot curbing | <input checked="" type="checkbox"/> Yes <input type="checkbox"/> No |
| Grave/family plot fencing | <input checked="" type="checkbox"/> Yes <input type="checkbox"/> No | Gravehouse(s) | <input type="checkbox"/> Yes <input type="checkbox"/> No |
| Tabernacle(s) | <input type="checkbox"/> Yes <input checked="" type="checkbox"/> No | Seating areas, benches | <input type="checkbox"/> Yes <input type="checkbox"/> No |
| Segregated burials | <input type="checkbox"/> Yes <input checked="" type="checkbox"/> No | Well(s) | <input type="checkbox"/> Yes <input type="checkbox"/> No |
| Others (e.g., urns, gazebo) | _____ | | |

LANDSCAPING

- | | | | |
|-------------|---|--------------|---|
| Flower beds | <input type="checkbox"/> Yes <input checked="" type="checkbox"/> No | Ground cover | <input checked="" type="checkbox"/> Yes <input type="checkbox"/> No |
| Shrubbery | <input checked="" type="checkbox"/> Yes <input type="checkbox"/> No | Trees | <input checked="" type="checkbox"/> Yes <input type="checkbox"/> No |
| Terracing | <input type="checkbox"/> Yes <input checked="" type="checkbox"/> No | Walkway(s) | <input type="checkbox"/> Yes <input checked="" type="checkbox"/> No |
| Others | _____ | | |

Approval of County Historical Commission
The application must be approved by the County Historical Commission (CHC) before forwarding to the THC.

GENE HOBART
Printed Name of CHC chair or marker chair

[Signature]
Signature

Mailing Address:

Daytime Phone: _____ Fax: _____

Date: 11-03-04 Email: _____



Scale: 1:24,000 (1" = 2000')
EDINBURG 12 MI. PHARR 5 MI.
US Dept. of the Interior, Geological Survey, 1962
181 182 183 10'

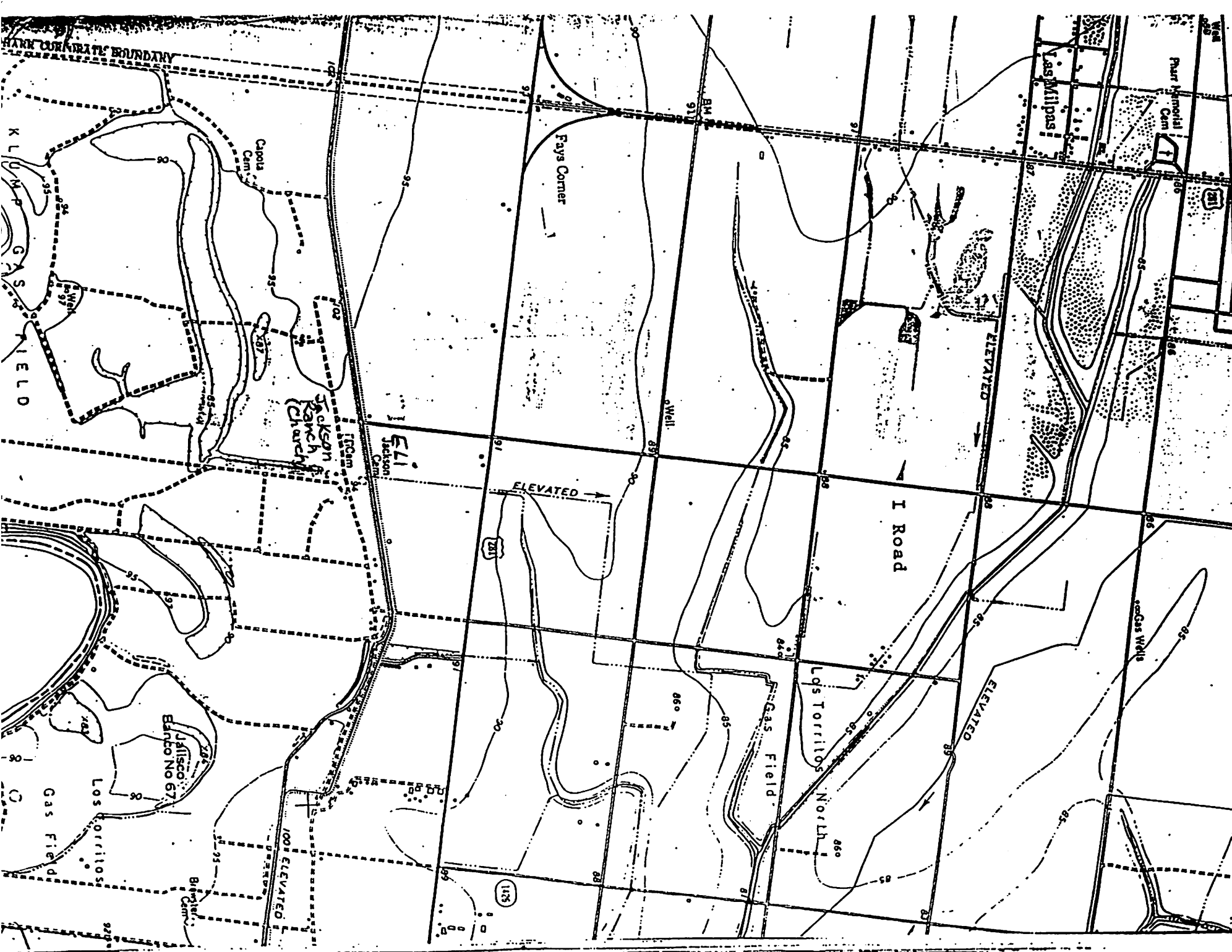

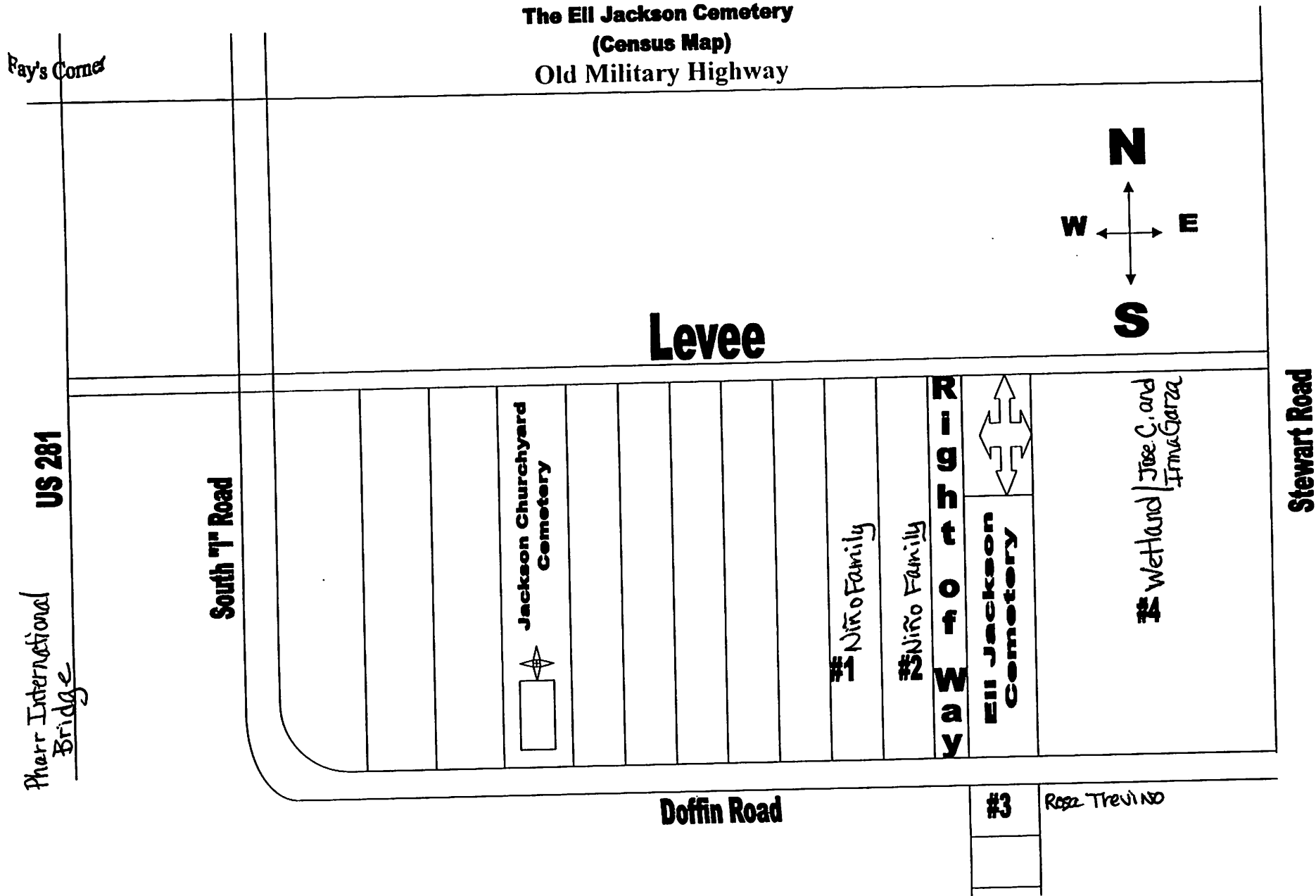

November 25, 2003

Eli Jackson Cemetery Survey Map from Hidalgo County Appraisal District Records